



---

# SAFETY GUIDELINES

---

IN LOGISTICS

Warsteiner Brauerei · Haus Cramer KG



## CONTENT

- Safety information and measures
- Measures and behaviour in an emergency
- Rescue information
- Map



**WARSTEINER**  
FAMILIENTRADITION  SEIT 1753

---

# SAFETY INFORMATION

---

## PICTOGRAMS & RULES IN LOGISTICS

### SAFETY INFORMATION



Wearing a high-visibility vest is mandatory for all persons throughout the warehouse.



Foot protection. The warehouse may only be entered by persons wearing safety shoes.



Please note that smoking and drinking alcohol are prohibited in the warehouse.



All persons driving powered vehicles anywhere on the site must have a blood alcohol level of 0.0%.



The maximum speed for vehicles in the warehouse is 10km/h.



Forklift and electric vehicles present a hazard in all areas of the site. Please pay particular attention.

### SAFETY MEASURES

All persons in the warehouse must follow the instructions of the shift coordinator.

No-one except the driver may leave the vehicle.

Children are strictly prohibited in the warehouse. Leaving the vehicle is not permitted.

Only vehicles suitable for beverage transport (VDI 2700 Sheet 12) are loaded, in accordance with the BGD 29 accident prevention provisions.

The permissible total weight must not be exceeded.

The driver shall secure the load in accordance with § 412 HGB and § 22 StVO. Lashing straps can be obtained from the porter.

The aids provided in the warehouse, e.g. ladders, must be used where necessary.

# WARSTEINER BRAUEREI

MAP

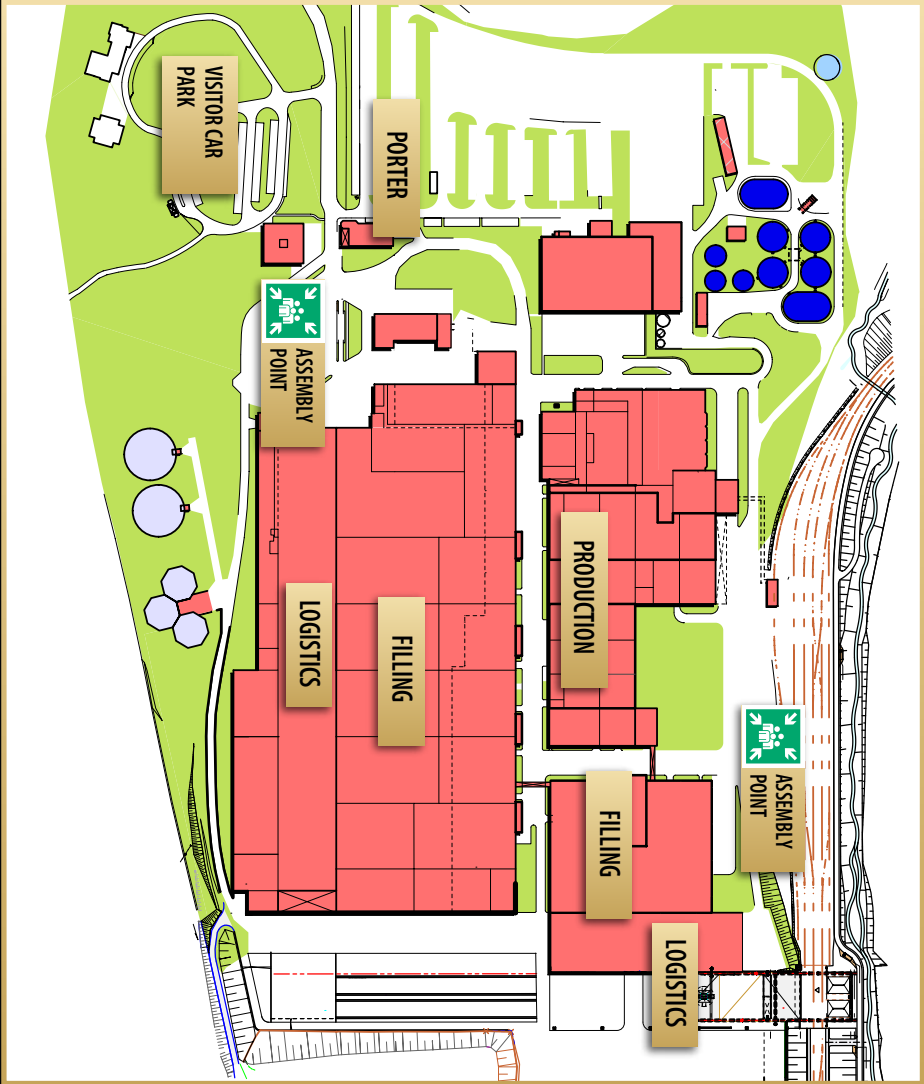

# MEASURES

## IN AN EMERGENCY

In an emergency, please note the following information signs:



First aid



Assembly point



Stretcher



Defibrillator



Emergency exit



Fire extinguisher



Escape route



Fire alarm button

## BEHAVIOUR IN AN EMERGENCY

Proceed to the nearest emergency exit, following the escape route signs. Tell the coordinator when you arrive at the assembly point.

See map to find your assembly point.

## REPORTING AN EMERGENCY

In an emergency, always state the following:

- Who is reporting (name)?
- What has happened (incident)?
- Where did it happen (site and building/floor)?
- Send someone to the porter to receive the emergency services

## EMERGENCY NUMBER

General: 0-112

Internal: 1281